



Enfields Hythe
3 Marsh Parade,
Hythe, Southampton,
Hampshire, SO45 6AN
T 023 8084 9210
E sales-hythe@enfields.co.uk

Ocknell Grove, Dibden, Southampton, SO45 5WD

Offers Over £280,000

🛏️ 4 🚿 2 🚗 1



We are delighted to present this lovely 4 bedroom family home situated in a quiet location, close to local amenities.

Located in a sought-after area, this inviting property will make a great family home with 4 bedrooms, a family bathroom, a downstairs cloak-room, an open kitchen/living room and both front and back garden.

This two floor townhouse has a large master bedroom on the ground floor, which can easily be turned into a generous master suite with an en-suite bathroom, or it can be used as a dining room, lounge or playroom if you don't need 4 bedrooms.

In front of the house, the garden has a cute picket fence all around and lawn with a tiled path to the entrance door. The rear garden is furnished to an idyllic space for both relaxation and practicality, featuring a tiled patio across the full width, a little fish pond, an outside tap, and an uncultivated area leading to a two-car driveway accessed via wooden gates. A shed is also included for additional storage.



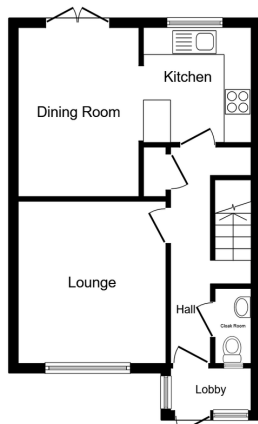

Ground Floor
Floor area 40.4 m² (435 sq.ft.)

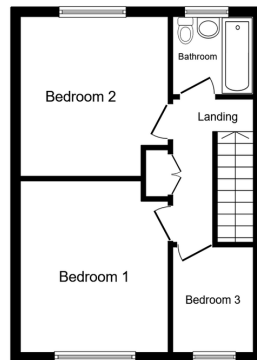

First Floor
Floor area 38.5 m² (414 sq.ft.)

TOTAL: 78.9 m² (849 sq.ft.)

This floor plan is for illustrative purposes only. It is not drawn to scale. Any measurements, floor areas (including any total floor area), openings and orientations are approximate. No details are guaranteed, they cannot be relied upon for any purpose and do not form any part of any agreement. No liability is taken for any error, omission or misstatement. A party must rely upon its own inspection(s). Powered by www.Propertybox.co.uk

- 4 BED ROOMS
- PARKING FOR 3 CARS
- DOWNSTAIRS W.C.
- SOUTH-WEST FACING BACK GARDEN
- GARDEN SHED
- LOVELY GARDENS
- FAMILY BATHROOM
- MODERN OPEN KITCHEN/LIVING ROOM
- SOUGHT AFTER AREA
- CALL TO BOOK A VIEWING

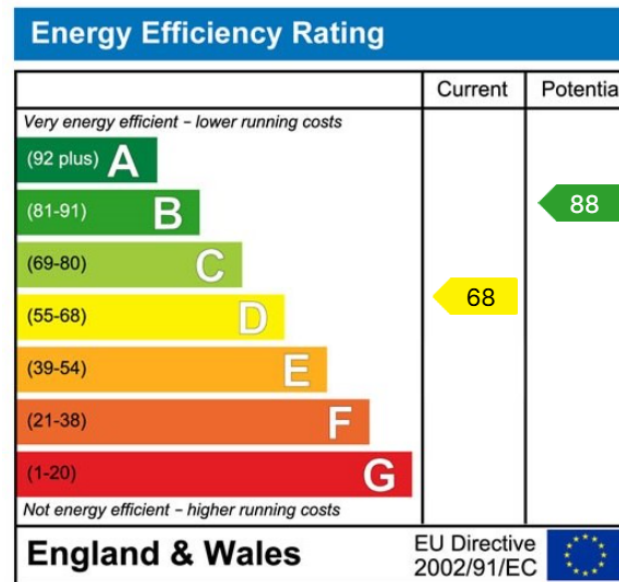

www.enfields-southampton.co.uk



It is Enfields policy to respect any sole agency currently in force and we would not be able to commence marketing until this has expired or been terminated. If you fail to terminate any previous agreement you could be liable for two sets of fees. Enfields Hythe is a trading name of YTF LTD Registered office: 345 Shirley Road, Southampton, Hampshire, England, SO15 3JD. Company Registration No: 10459987. VAT Registration No: 281 2975 81.

Enfields Lettings - Embley Management LTD T/A Enfields. Registered Address: 345 Shirley Road, Southampton, Hampshire, England, SO15 3JD. Company Registration No: 14847604. VAT Registration No: 439 8546 45.

